

Universal High-Reliable High-Precision High-Speed solder-paste Printer

YGP

- Use of 3S head enables ideal printing condition settings.
- High-speed printing tact 12.3 sec ! (Under optimum conditions / normal printing / without using flaps)
- Applied printing pressure feedback control.
- Sturdy frame and highly rigid printing table assure high printing quality and stability.
- Applicable to stencil frames of various sizes.
- No adapter is required and the set-up procedure is simple and speedy.



Note : The photo shows the state with various options installed.

3S head (3S : Swing Single Squeegee) + Printing pressure feedback control

The squeegee attack angle can be set freely and simply. Using this feature together with the variable squeegee speed and printing pressure, ideal printing conditions are assured. At the same time, excessive consumption of solder paste is reduced and its falling in drops is prevented. The set-up and maintenance convenience is also improved.

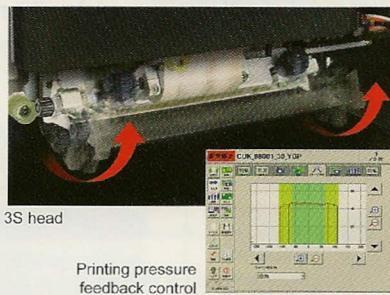

3S head

Printing pressure feedback control

Print inspection camera



Automatic cleaning system

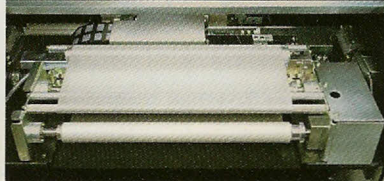

Graphical layer base alignment function

Even when the stencil opening shape and the PCB pattern shape are different, images from two cameras are combined in layer, thereby operation of the PCB to printing stencil relative positioning can be performed simply and accurately.

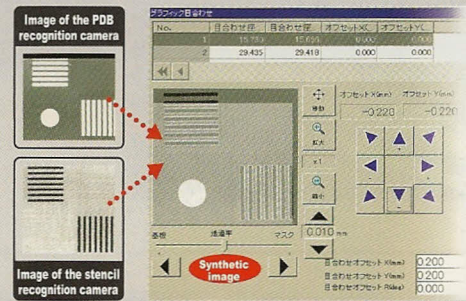

Conveyer extension on exit side

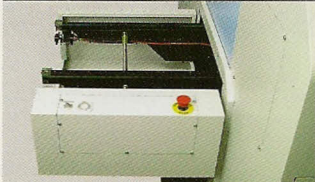

The mask without adapter can be fixed

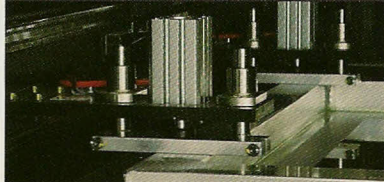

YGP specifications (Model : KGY-000)

		YGP				
Applicable PCB		L420 x W360mm to L50 x W50mm				
Printing heads		3S head (3S : Swing Single Squeegee) or Double squeegee head / Either metal squeegee or urethane squeegee to be selected Printing speed : 2 to 200mm/sec Printing pressure : 5 to 200N +/-2N (Feedback control by load cell)				
Printing accuracy		Printing accuracy (3σ) : +/-0.025mm, positioning repeatability (3σ) : +/-0.005mm				
Printing line tact		12.3sec (Normal printing)(Without using flaps)(Under optimum conditions) 13.2sec (Normal printing)(With using flaps)(Under optimum conditions) 19.2sec (Normal printing + Cleaning)(Under optimum conditions) 11.0sec (24 capture-images inspection)(Under optimum conditions : When the PCB size is L180mm x W130mm)				
Applicable stencil size <Note 1>		L750 x W650mm	L736 x W736mm (Recommended)	L650 x W550mm (Recommended)	L600 x W550mm	L550 x W650mm
Applicable PCB (mm)	L420 x W360mm	—	○	—	—	—
	L420 x W350mm	○	○	—	—	—
	L330 x W250mm	○	○	○	○	○
Power supply		3-phase AC 200/208/220/240/380/400/416V +/-10% 50/60Hz				
Air supply source		0.55MPa or more, in clean, dry state				
External dimension <Note2>		L1,820 x W1,705 x H1,510mm (cover top)				
Weight		Approx. 1,730kg				

<Note 1> Applicable= ○

<Note 2> This dimension does not include the projection.